

HAMMOCK OAKS LEGEND

- MARKET RATE LOTS
 - TOWNHOMES (16')
 - TOWNHOMES (24')
 - 50' LOTS (50')
 - 35' LOTS (40')
- AGE-RESTRICTED LOTS
 - 40' LOTS (40')
 - 50' LOTS (50')
 - 60' LOTS (60')

HAMMOCK OAKS LOT COUNT

PHASE	MARKET RATE LOTS				AGE RESTRICTED LOTS			TOTALS
	TH (16')	TH (24')	35'	50'	40'	50'	60'	
1A	0	0	0	49	30	35	33	147
1B	66	48	0	0	0	0	0	114
1C	0	0	54	0	0	0	0	54
2A	0	0	0	45	0	0	0	45
2B	70	46	0	0	0	0	0	116
2C	0	0	42	0	0	0	0	42
2D	0	0	0	0	21	69	40	130
3	0	0	0	0	1	90	64	155
4	0	0	0	0	92	54	14	160
5	0	0	0	0	46	81	12	139
6	0	0	0	0	1	26	13	40
TOTALS	136	94	96	94	191	355	176	1,142

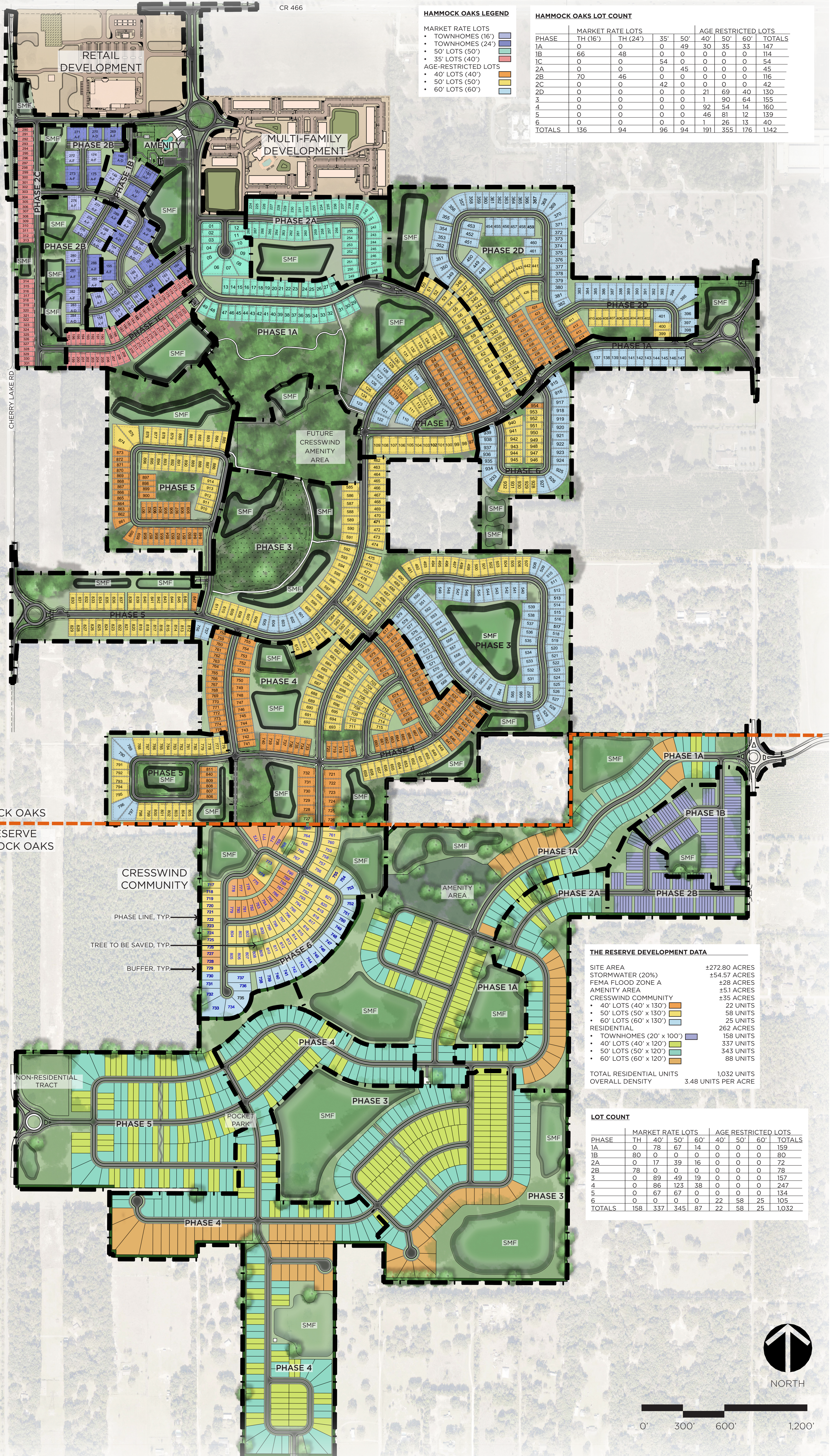

HAMMOCK OAKS
THE RESERVE AT HAMMOCK OAKS

CRESSWIND COMMUNITY
PHASE LINE, TYP.
TREE TO BE SAVED, TYP.
BUFFER, TYP.

THE RESERVE DEVELOPMENT DATA

SITE AREA	±272.80 ACRES
STORMWATER (20%)	±54.57 ACRES
FEMA FLOOD ZONE A	±28 ACRES
AMENITY AREA	±51 ACRES
CRESSWIND COMMUNITY	±35 ACRES
• 40' LOTS (40' x 130')	22 UNITS
• 50' LOTS (50' x 130')	58 UNITS
• 60' LOTS (60' x 130')	25 UNITS
RESIDENTIAL	262 ACRES
• TOWNHOMES (20' x 100')	158 UNITS
• 40' LOTS (40' x 120')	337 UNITS
• 50' LOTS (50' x 120')	343 UNITS
• 60' LOTS (60' x 120')	88 UNITS
TOTAL RESIDENTIAL UNITS	1,032 UNITS
OVERALL DENSITY	3.48 UNITS PER ACRE

LOT COUNT

PHASE	MARKET RATE LOTS				AGE RESTRICTED LOTS			TOTALS
	TH	40'	50'	60'	40'	50'	60'	
1A	0	78	67	14	0	0	0	159
1B	80	0	0	0	0	0	0	80
2A	0	17	39	16	0	0	0	72
2B	78	0	0	0	0	0	0	78
3	0	89	49	19	0	0	0	157
4	0	86	123	38	0	0	0	247
5	0	67	67	0	0	0	0	134
6	0	0	0	0	22	58	25	105
TOTALS	158	337	345	87	22	58	25	1,032

